



## Patch Panel HD ELISO 48 Ports

Straight and angled patch  
panel solutions

# Patch Panel HD ELISO 48 Ports.

Key features and advantages.

In today's densely populated world, space is crucial in every respect. The focus was on a very economical, lightweight and yet stable copper patch panel that takes up as little space as possible. Not only data centers benefit from the space savings, but also the office cabling.



- 1 «Special» Direct Attach
- 2 Front panel in grey or black with printed port numbers
- 3 Cable tray with a cable tie option
- 4 Optional cable guide for clicking in
- 5 Complete automatic earthing of the modules
- 6 Robust steel construction
- 7 Additional ground contact option





030.6677

## The HD ELISO patch panel family is the perfect partner

The HD patch panel family is complete. Whether angled or straight - the philosophy is the same. Slim, robust, simple and fast. Even the isolated use of a fiber optic connection is possible. Reusable cable guides facilitate fast assembly. Labeling, security systems or the R&MinteliPhy electronic infrastructure management system are supported.



030.6897

### «Special» Direct Attach

Click in, unlock with a small screw-driver. Simple and fast.

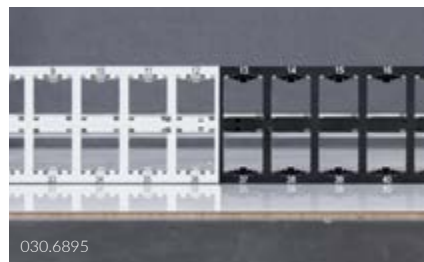

030.6895

### Front panel in grey or black

Adapts to your rack image. Printed port numbers - other numbers available on request.



030.6896

### Cable tray

Sturdy shelf with cable tie option or optional cable guide rails to click in.



030.5783, 030.6777

### Cable guides

Cable guides for cables from 5 to 8.5 mm, clickable, reusable, fast.



36

030.6897

### Automatic earthing of the modules

Fully automatic earthing thanks to steel frame plus additional earthing contact option.



030.6898

### Robust steel construction

Torsion-resistant steel frame. Guaranteed to hold and retain its shape even after loading during installation.

# Patch Panel HD ELISO 48 Ports.

## Your most important benefits.



### Established design

- Proven handling with simple click-in modules for quick replacement
- Snap-in cable guides for cable storage for fast assembly
- Flat angle with only 100mm overhang for angled version
- Attachable Labeling option for clear orientation



### Compatibility

- Can also accommodate Fiber Optic Adapters using special adapters
- Security System 1 to 3 is supported
- The patch panels are prepared for the use of R&MinteliPhy



### Robust

- Slim and sturdy metal construction with plastic bezel
- Tested and stable up to a weight of 10kg, so that nothing is sagging after installation

## Complementary products



### Modules

Connection modules from Cat. 6 to Cat. 8.1 for all needs.



### Outlets

Outlets of different sizes and shapes for your style.



### Patch cords

Very reliable connection to active and passive devices.

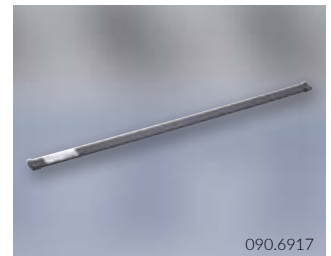

### R&MinteliPhy

Automated Infrastructure Management System (AIM) for the Digital Age.



We are represented by more than 100 qualified partners worldwide.  
Find your local partner at: [www.rdm.com](http://www.rdm.com)

